

Gli Ipogei di Wignacourt a Rabat

a cura di
Vittorio G. Rizzone e Federica Sabatini

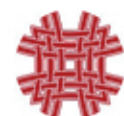

KASA
KOINE' | ARCHEOLOGICA
SAPIENTE | ANTICHITA'



TAVOLE FUORI TESTO

Tav. I - Planimetria generale
Scala 1:1000

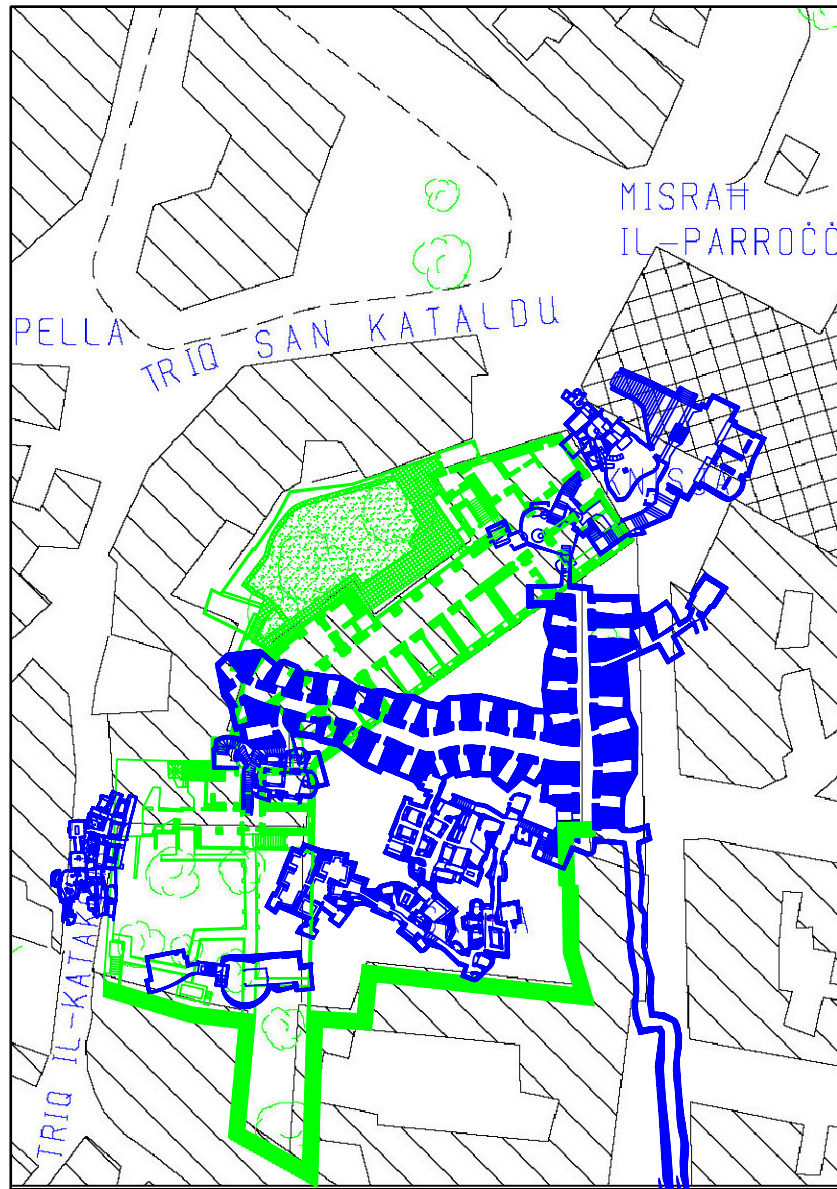

- Complesso epigeico di Wignacourt
- Complesso ipogeico di Wignacourt

Tav. II - Planimetria dei sotterranei di Wignacourt

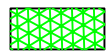
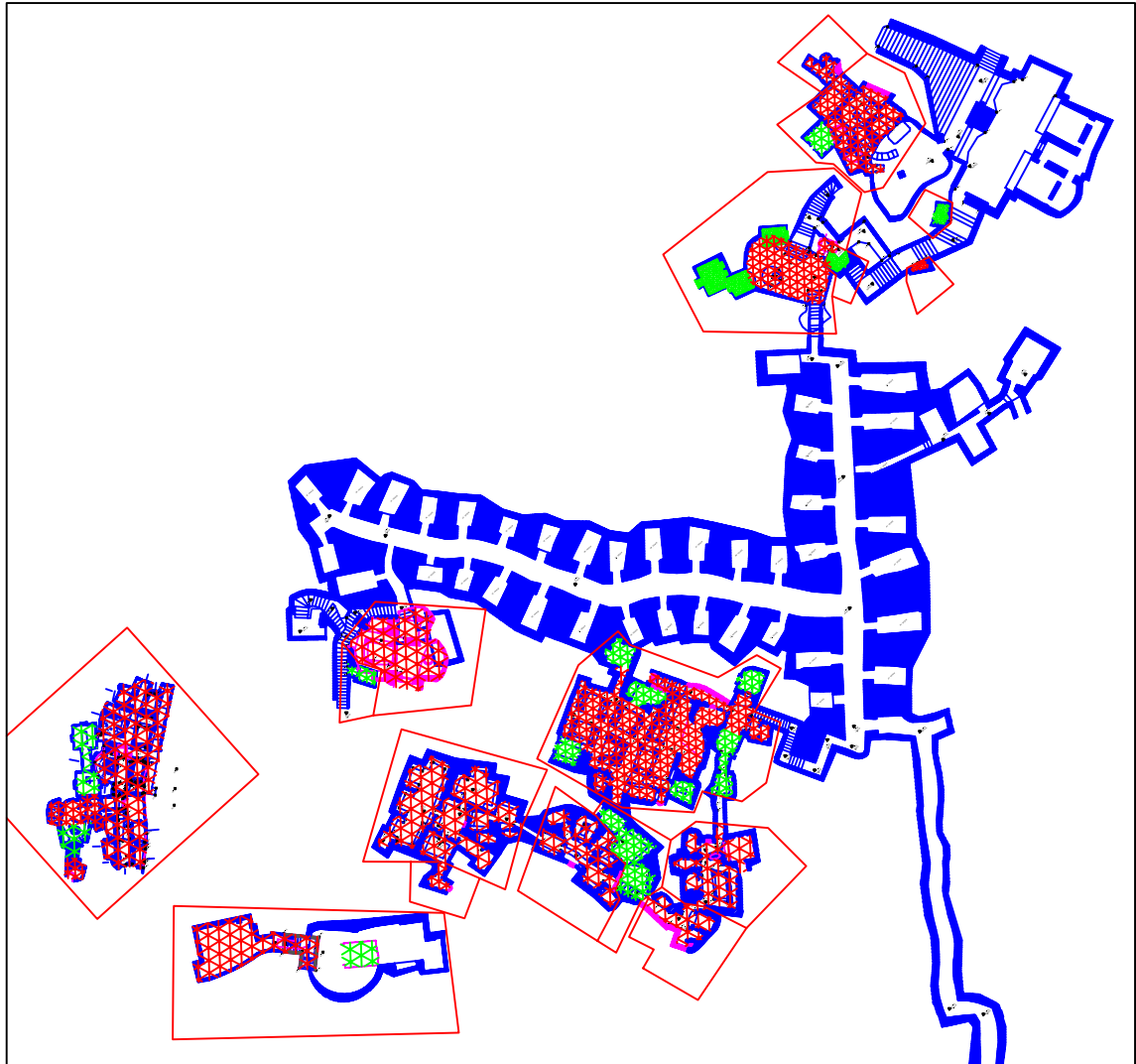

Tombe puniche



Tombe tardo-antiche

Tav. IV - Complessi ipogei 3 e 4
Scala 1:100

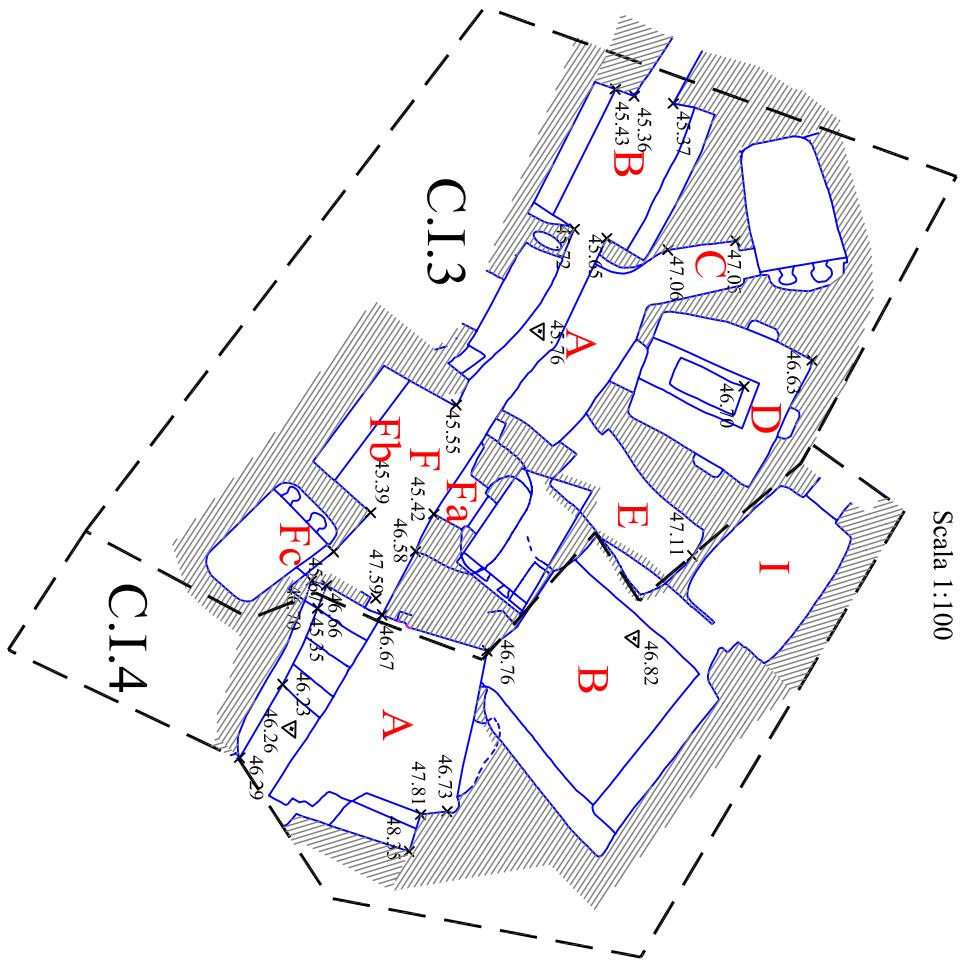

Tav. V - Complesso ipogeico 5
Scala 1:100

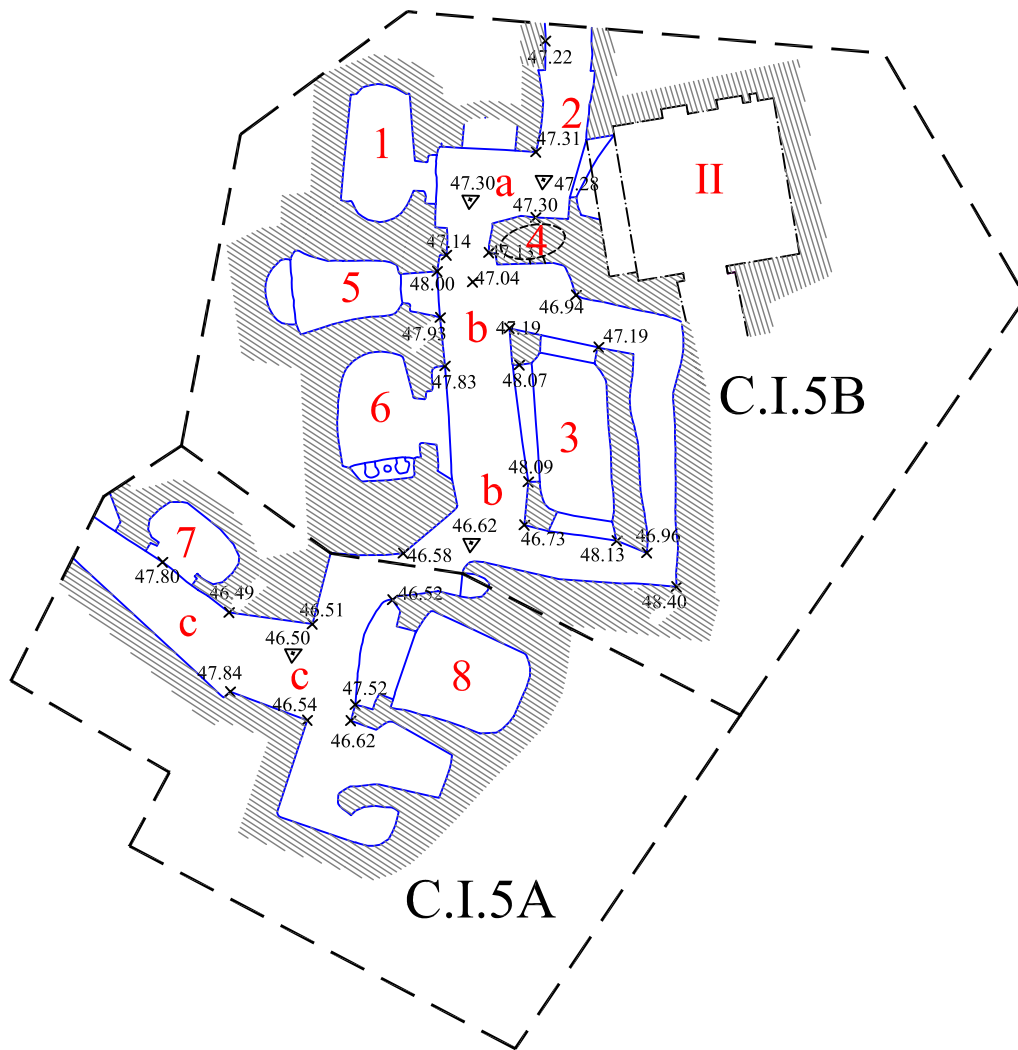

Tav. VI - Complesso ipogeico 6
Scala 1:120

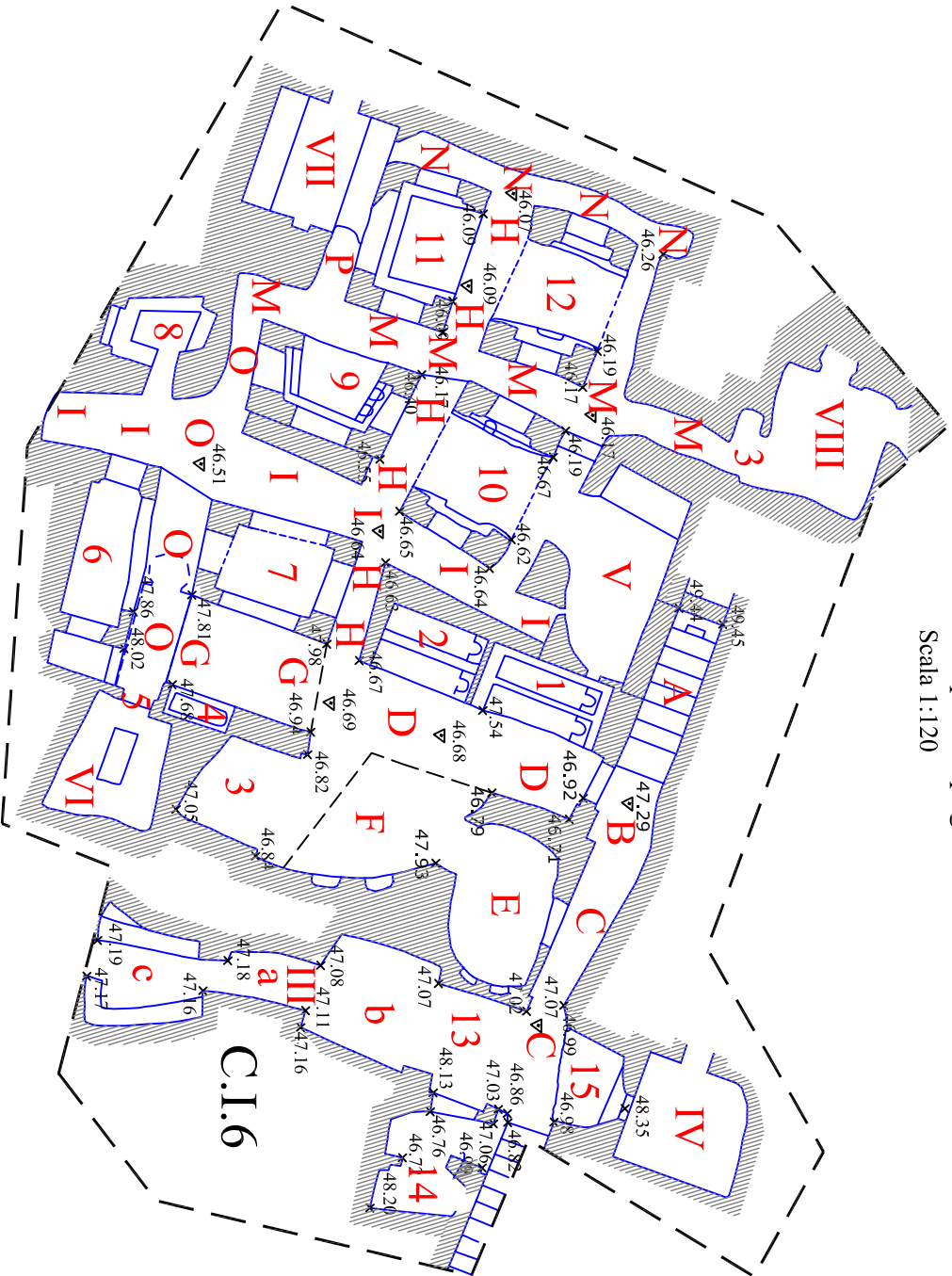

Tav. VIII - Complessi ipogei 10 e 11
Scala 1:100

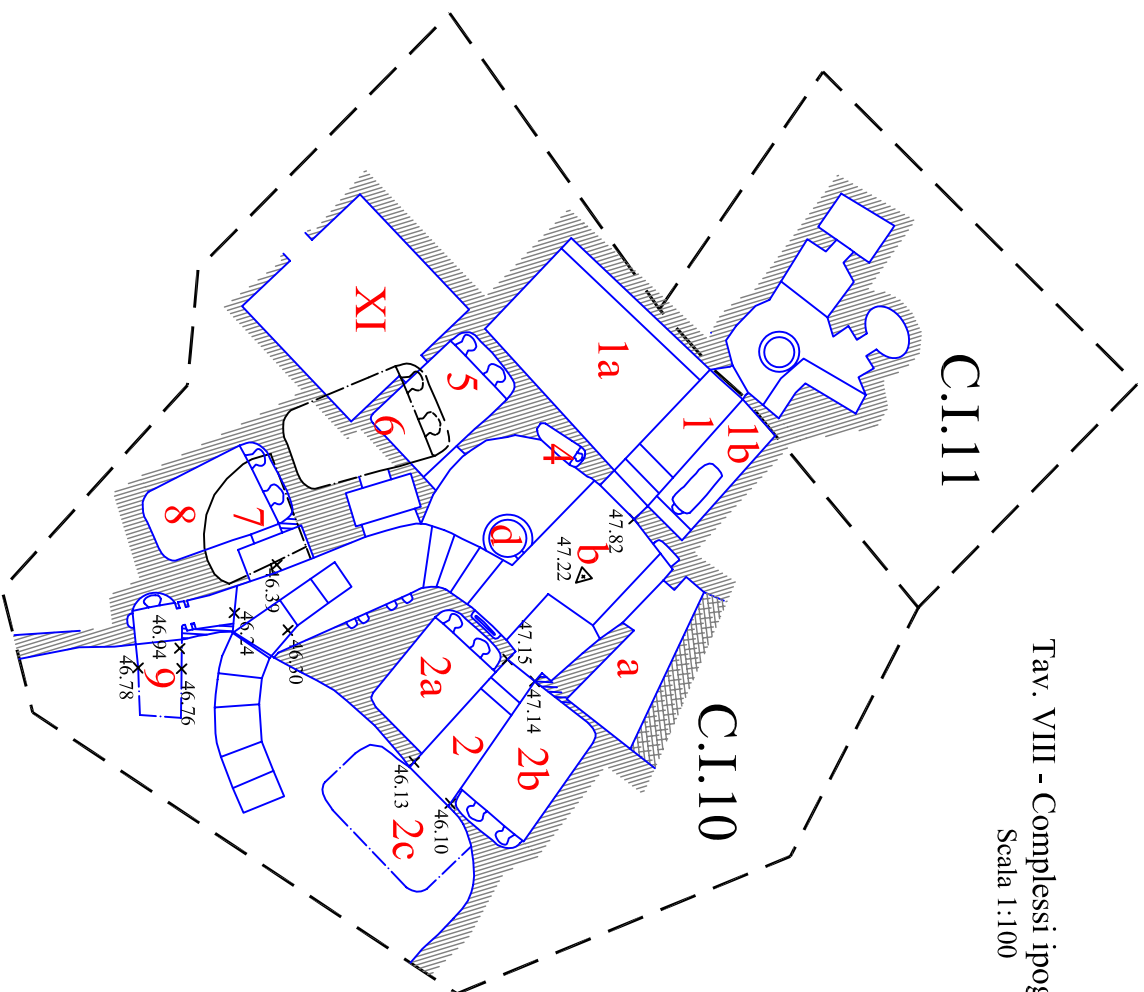

Tav. IX - Ipogei 13 e 14
Scala 1:100

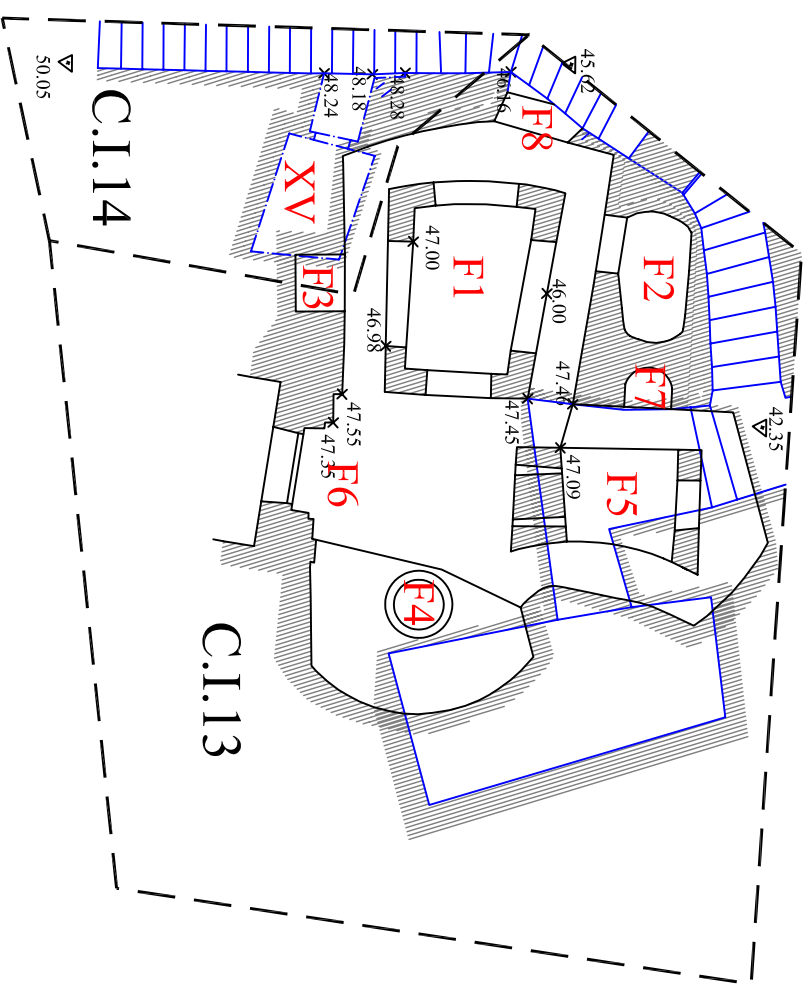

Tav. X - Complesso ipogeico 15
Scala 1:100

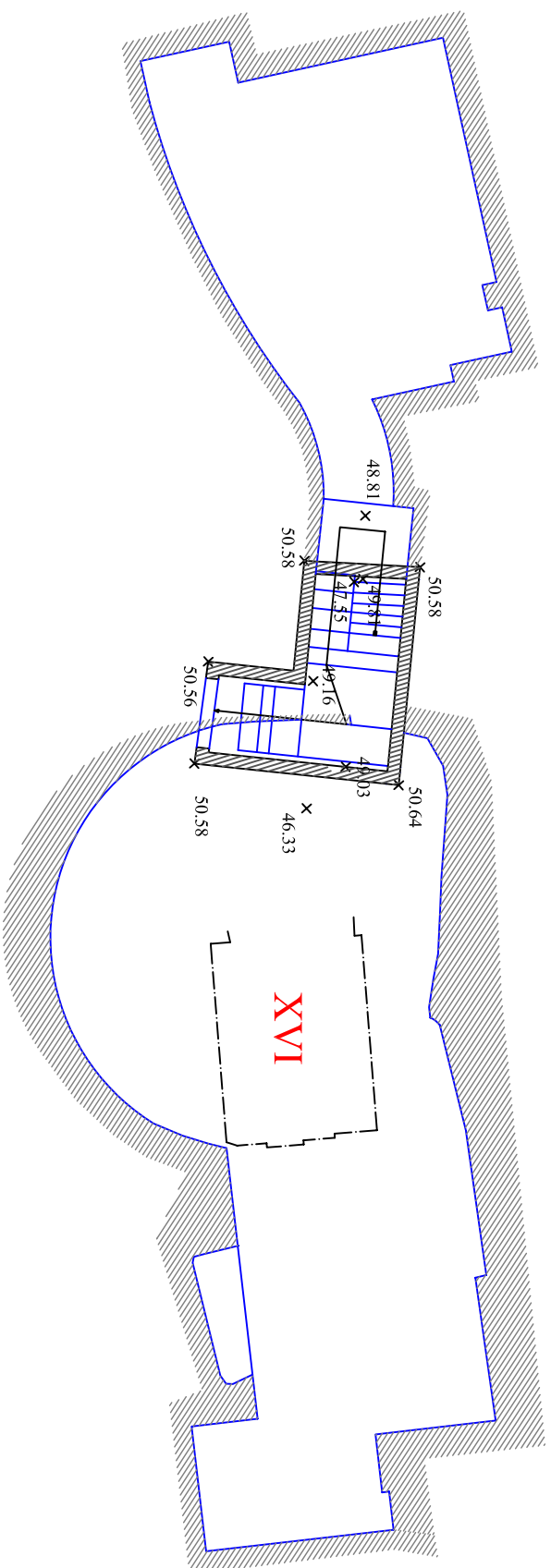

Tav. XI - Complesso ipogeico 16

Scala 1:100

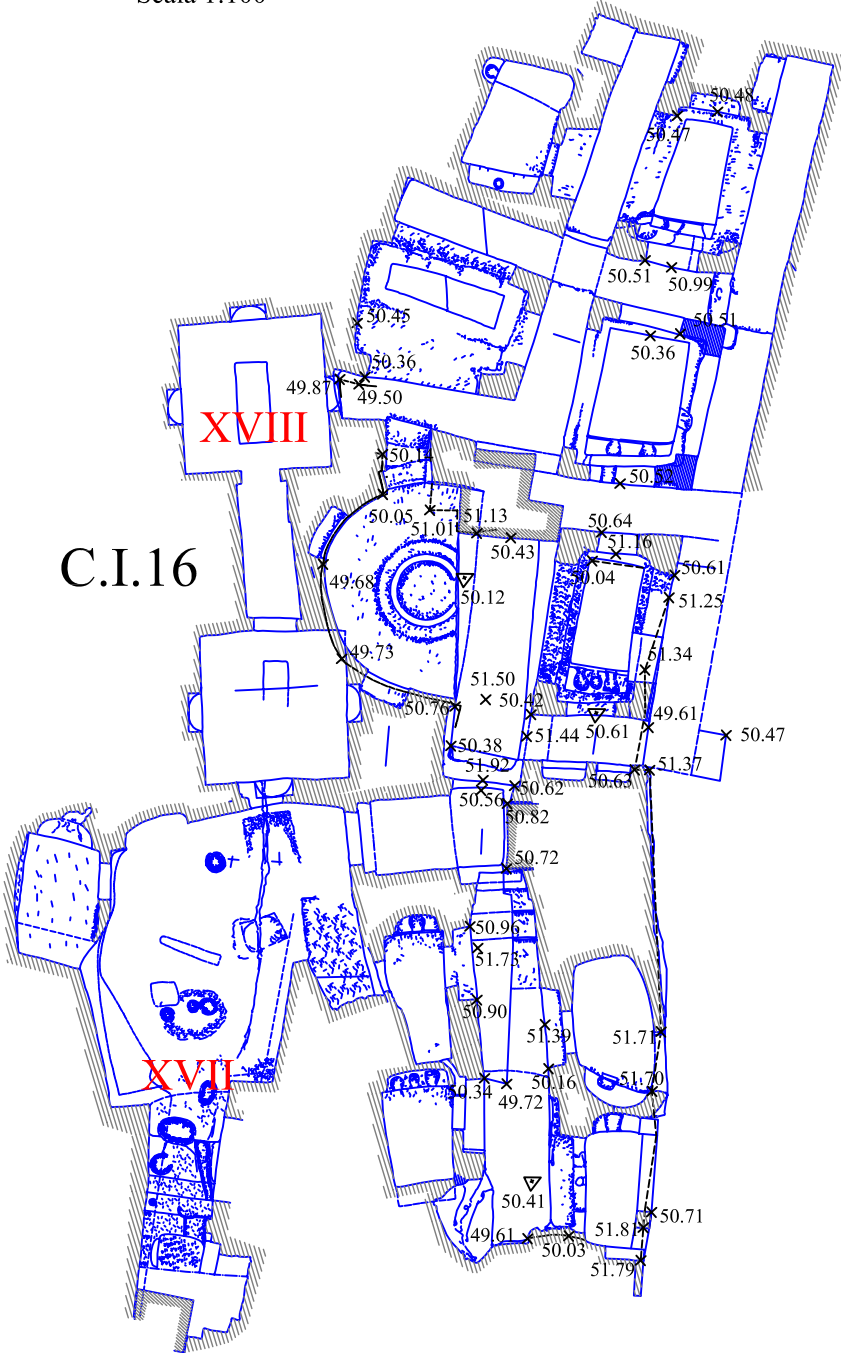

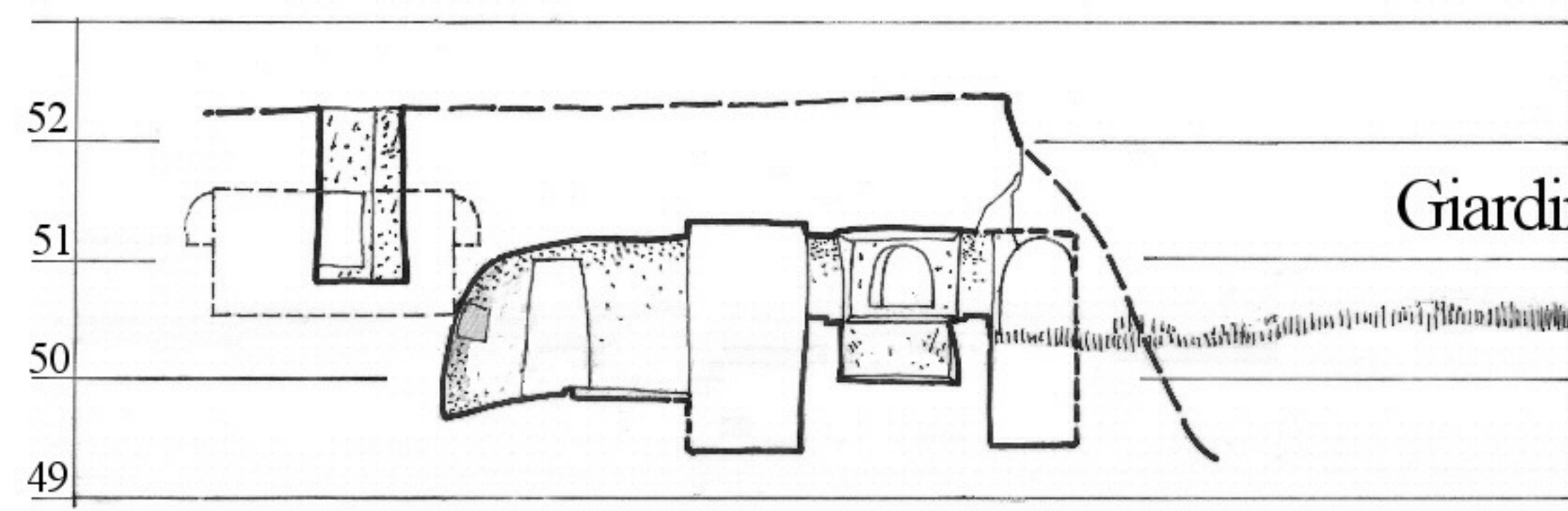

Ipogeo 16

Sezione B-B'

Giardino Sud del Museo Wignacourt

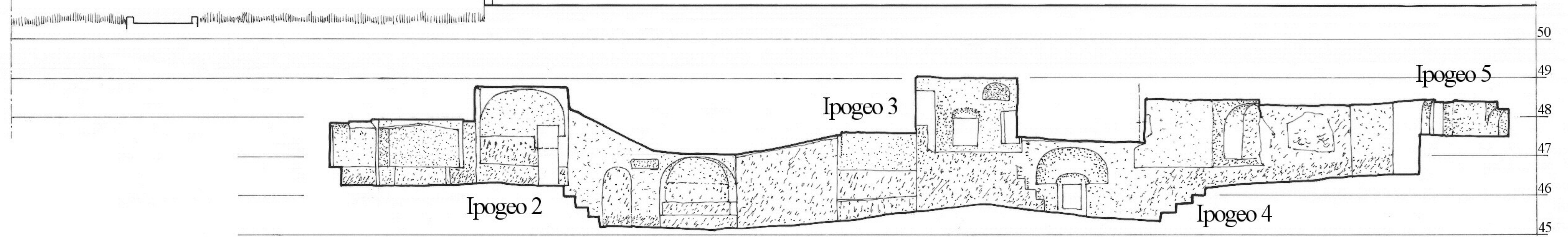

Ipogeo 2

Ipogeo 3

Ipogeo 4

Ipogeo 5

Cortile della Scuola Secondaria

Pianta

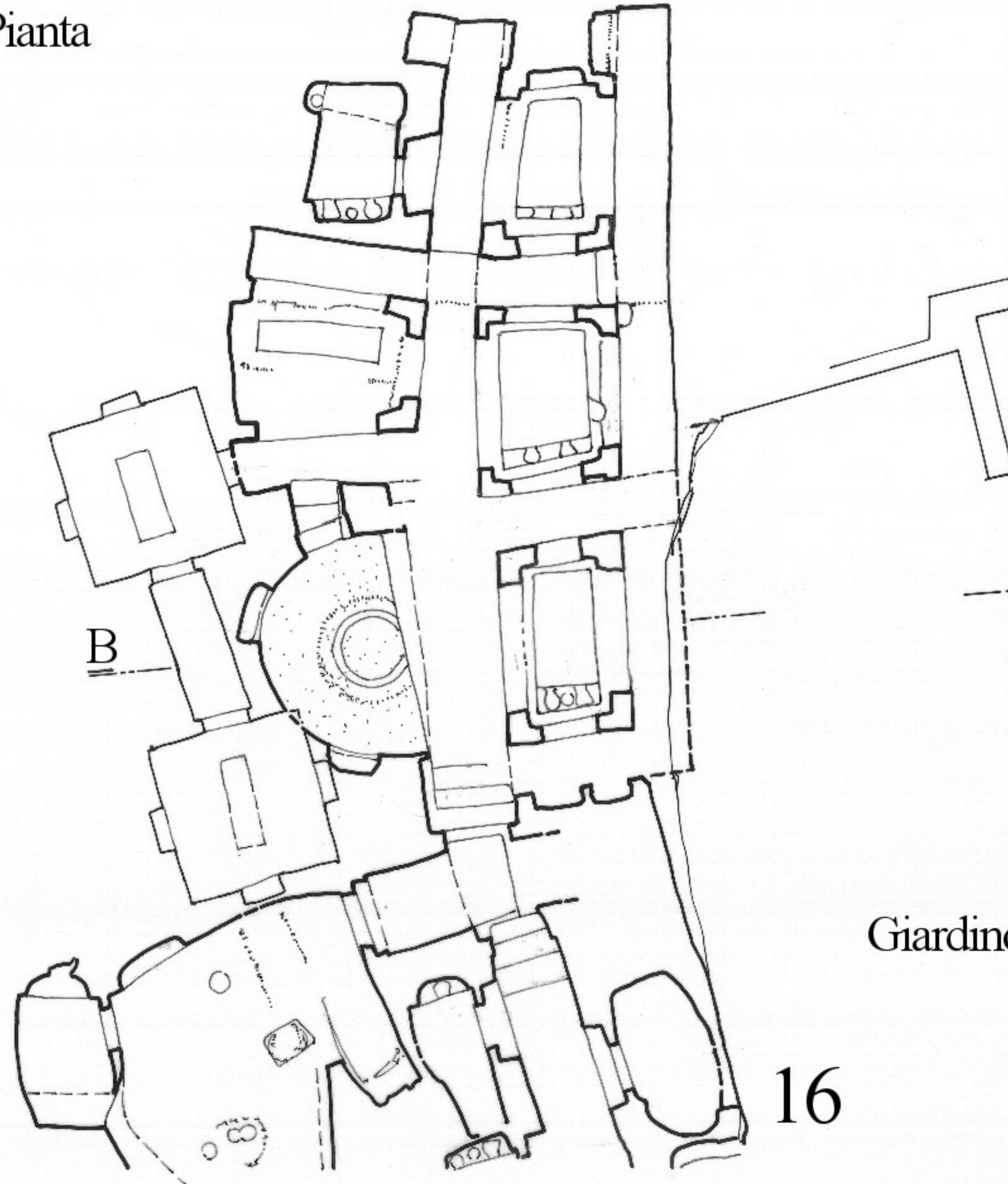

16

Giardino Sud del Museo Wignacourt

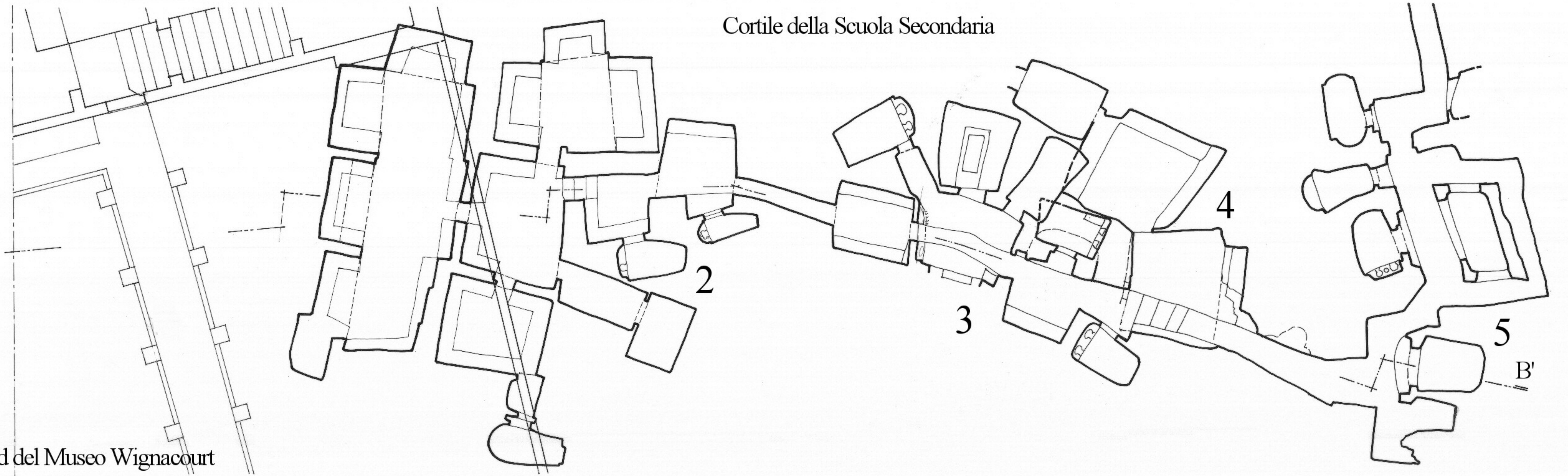

Cortile della Scuola Secondaria

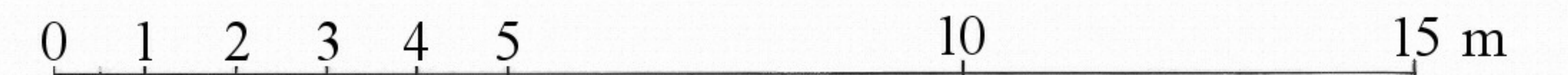

Catacombe Wignacourt - Ipogei 16, 2, 3, 4, 5

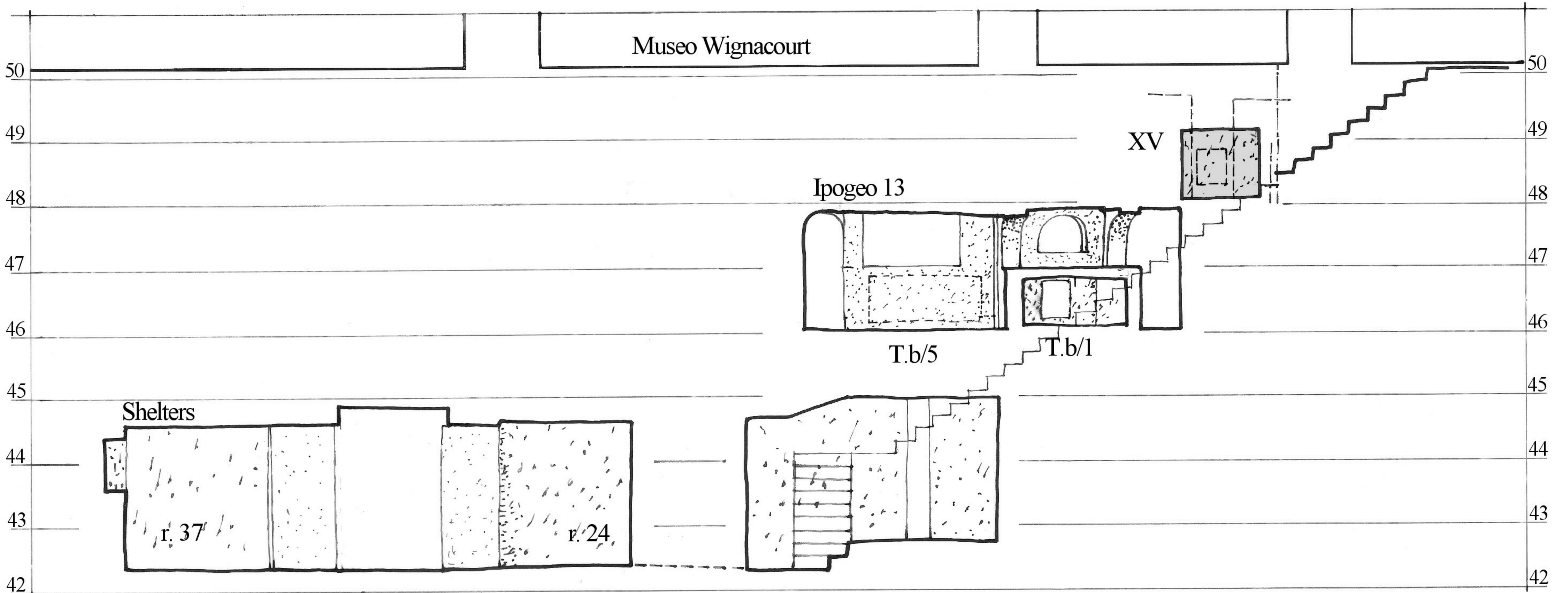

Sezione A-A'

Pianta

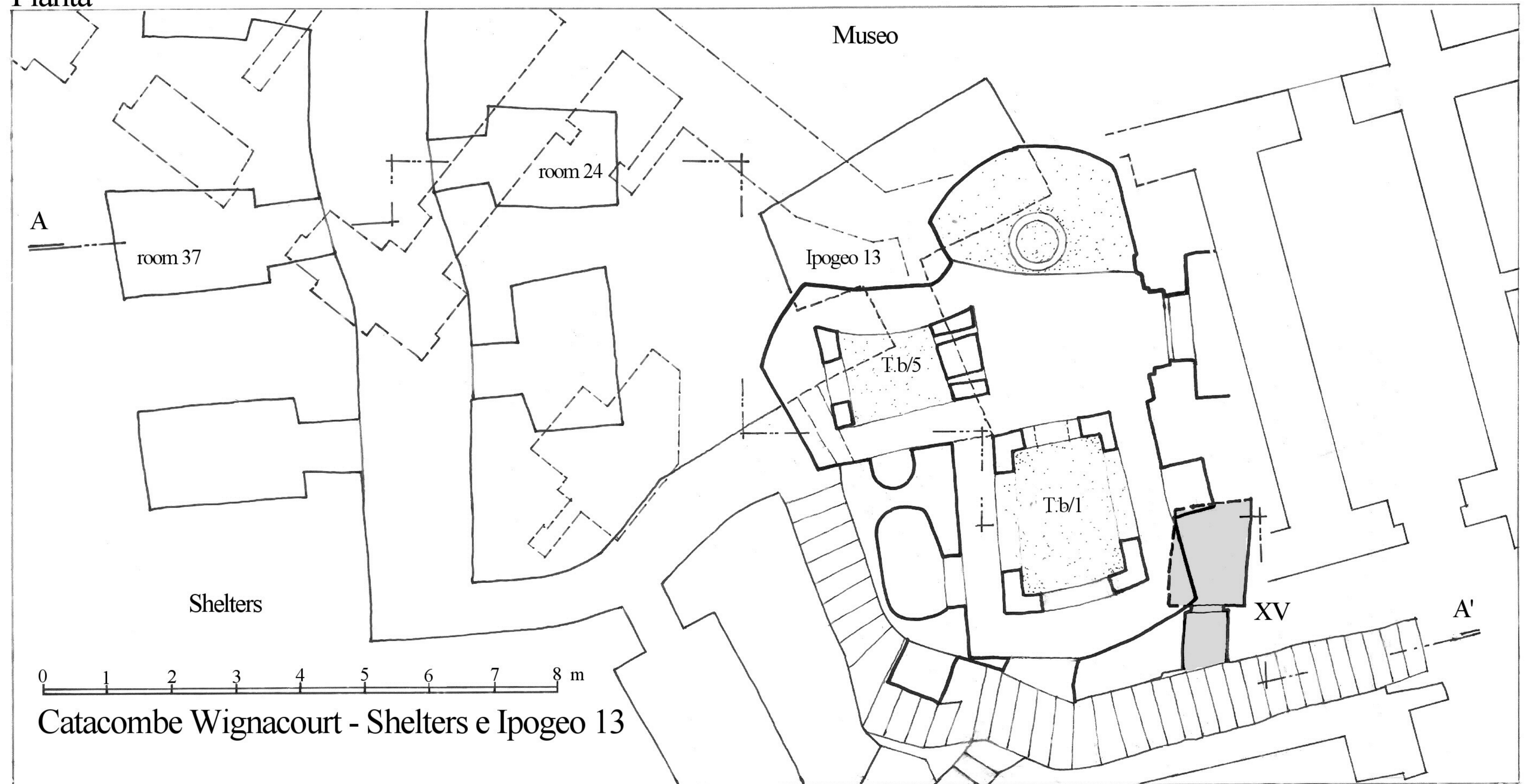

Catacombe Wignacourt - Shelters e Ipogeo 13



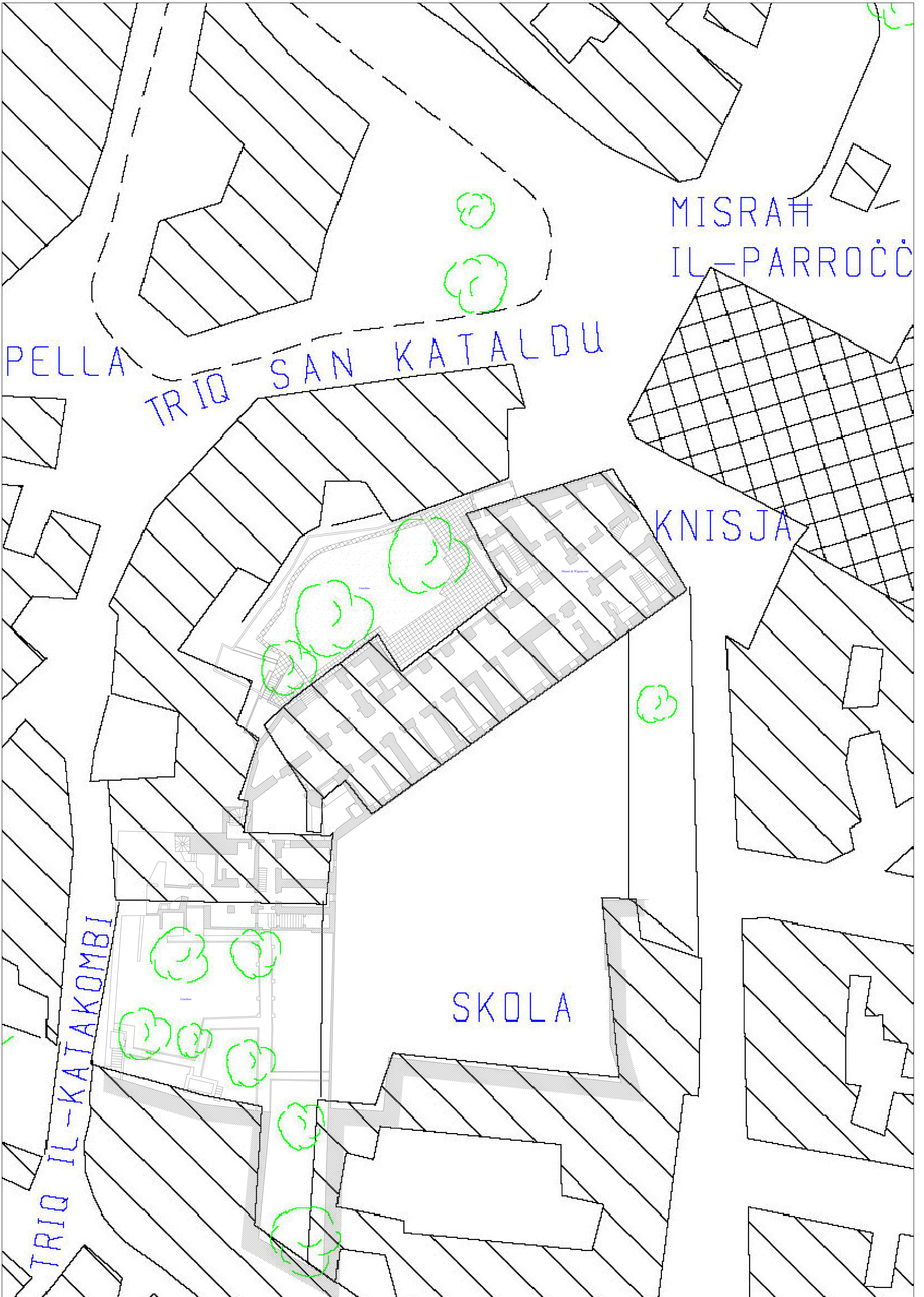

PLANIMETRIA GENERALE

Scala 1:200

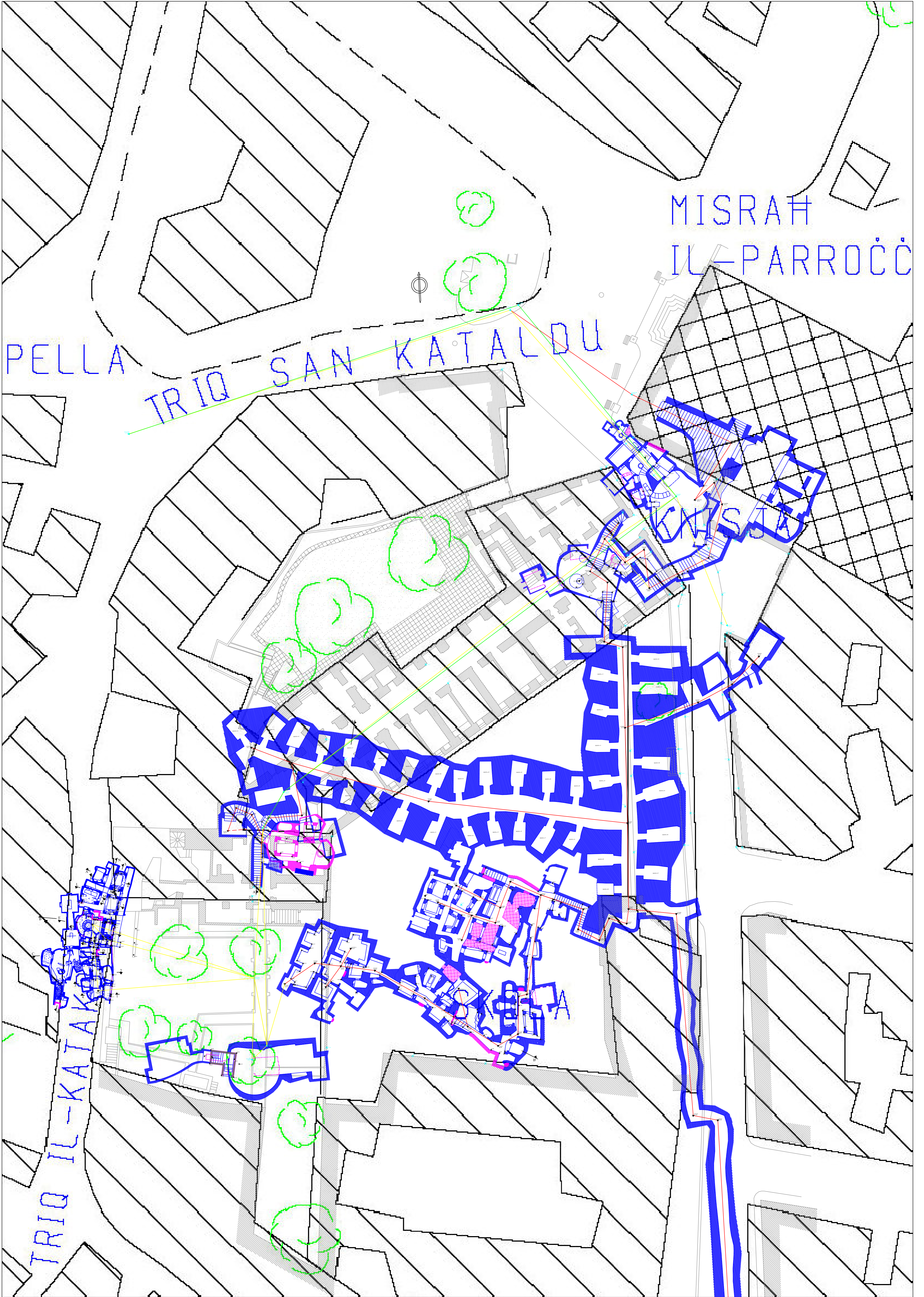

PLANIMETRIA GENERALE
Scala 1:100

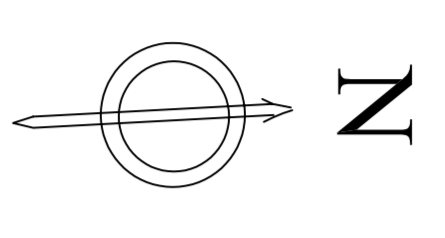

PLANIMETRIA DEI SOTTERRANEI DI WIGNACOURT

- Complesso epigeico di Wignacourt
- Complesso ipogeico di Wignacourt

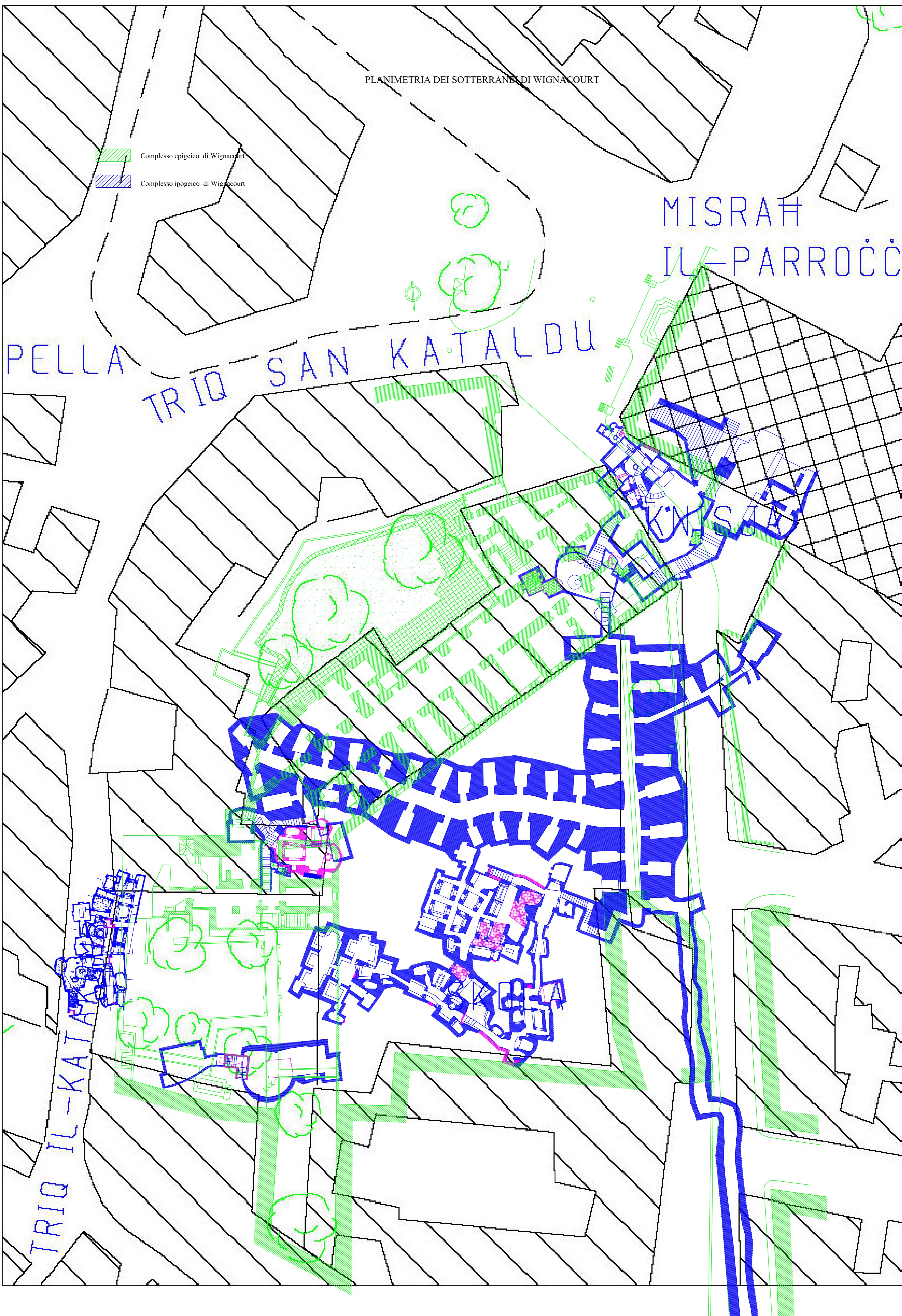

SOVRAPPOSIZIONE PLANIMETRICA

Scala 1:50

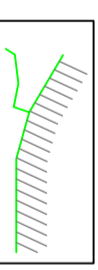
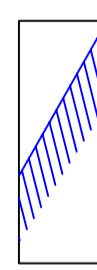

-  Rilievo topografico
-  Disegno antecedente di rilievo topografico